

'LectroSound

USER GUIDE

GUIDE DE L'UTILISATEUR

  astisupport.com

Warranty and Licensing Information:
Informations de garantie et de licence :

astisupport.com



/SoundOfSleep



hello@soundofsleep.com



/SoundOfSleep



/SoundofSleepOfficial

STEP ONE

Connect your LectroSound to any USB power source.
An AC to USB adapter is included for your convenience.

The USB connection is used for power only, and
not audio or data.

STEP TWO

Adjust the volume and tone to your liking.

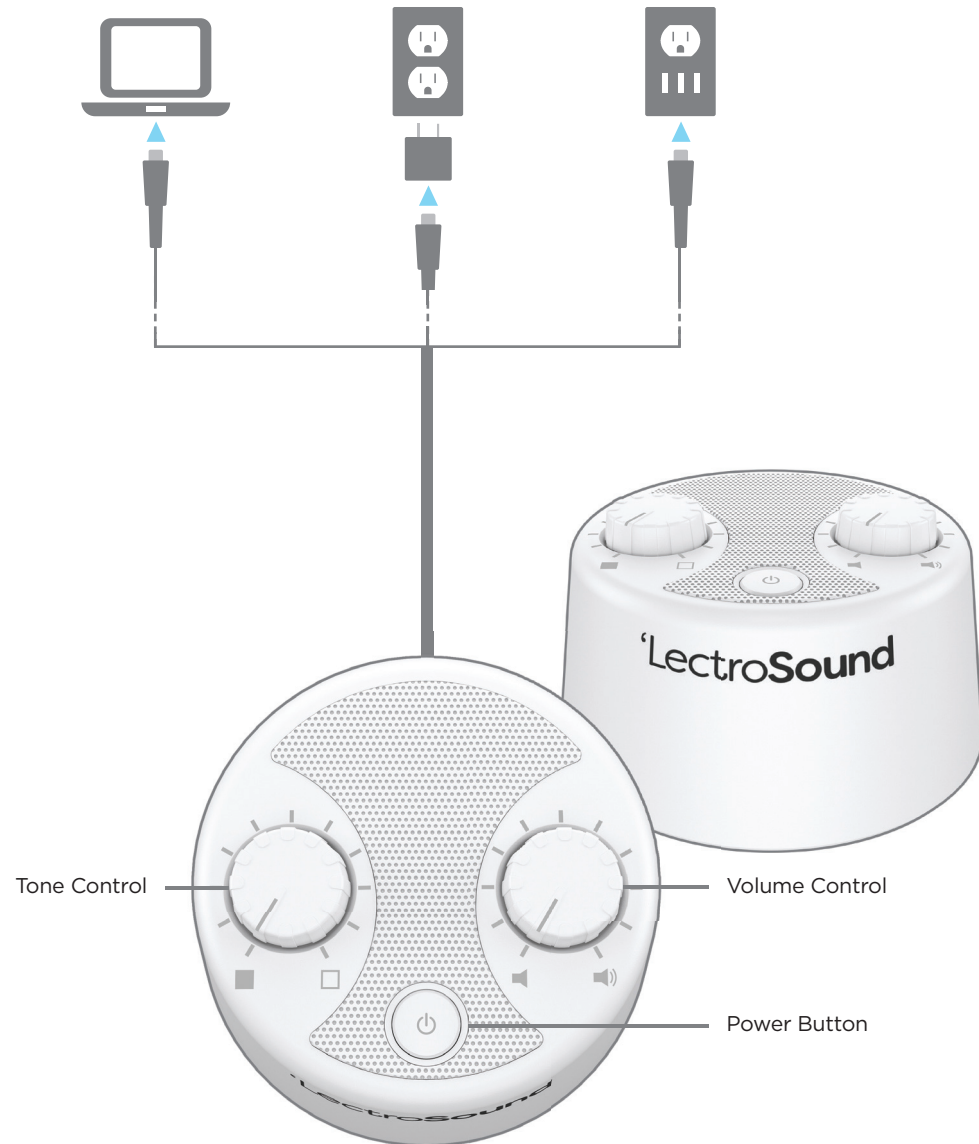

PREMIÈRE ÉTAPE

Connectez votre LectroSound à n'importe quelle source d'alimentation USB. Un adaptateur secteur vers USB est inclus pour votre confort.

La connexion USB sert uniquement à l'alimentation, et non à l'audio ou aux données.

DEUXIÈME ÉTAPE

Ajustez le volume et la tonalité à votre convenance.

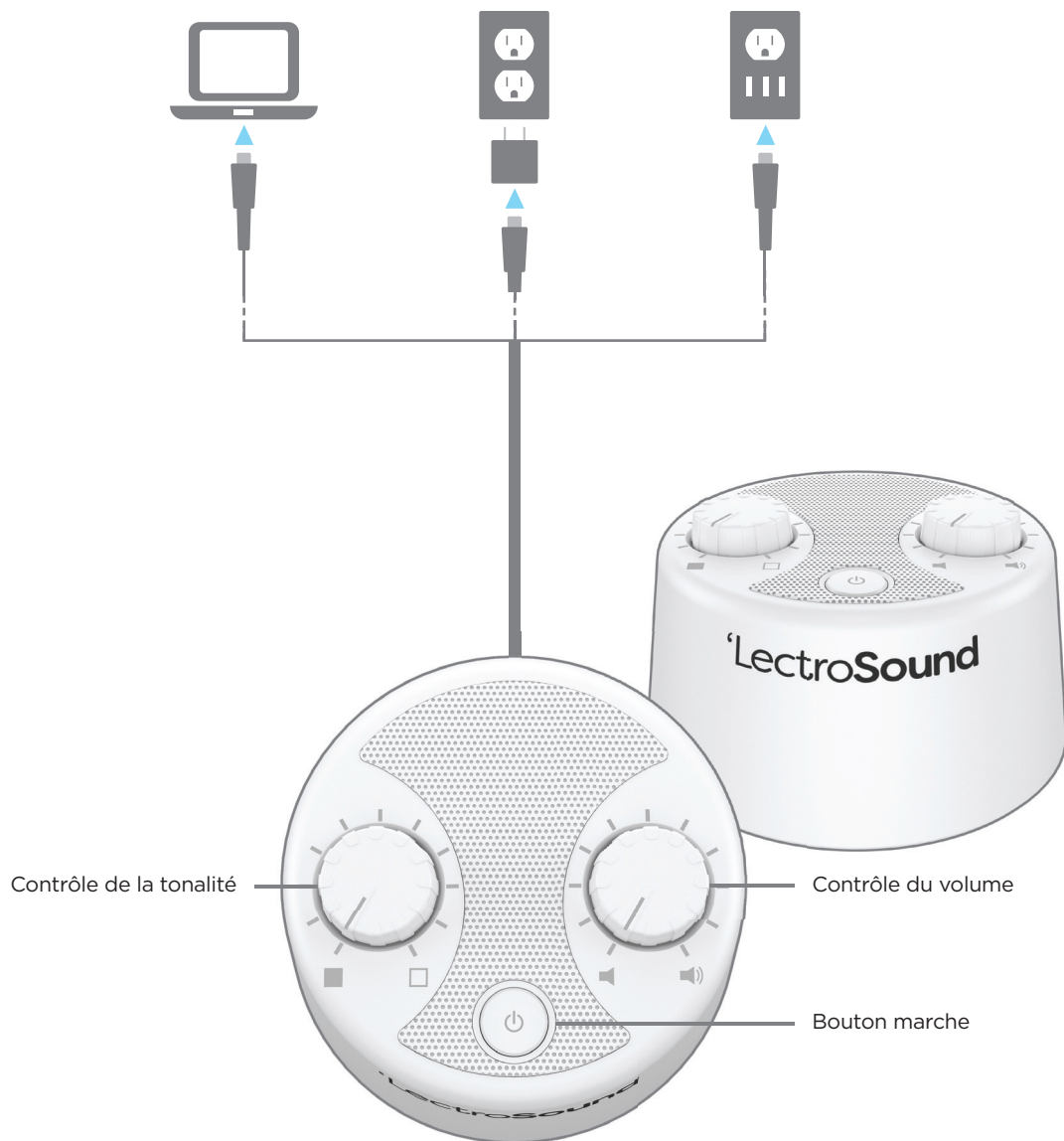

SoundofSleep.com

Adaptive Sound Technologies
1475 S. Bascom Ave., Suite 116
Campbell, California 95008
Phone: 408-377-3411
Fax: 408-558-9502
hello@soundofsleep.com

© 2018 Adaptive Sound Technologies, Inc. All Rights Reserved.
LectroSound, Adaptive Sound Technologies, the Sound of Sleep logo and the ASTI logo are trademarks or registered trademarks of Adaptive Sound Technologies, Inc. All other marks, including Bluetooth®, are registered trademarks of their respective owners.

This device complies with Part 15 of the FCC Rules. Operation is subject to the following two conditions: (1) This device may not cause harmful interference, and (2) this device must accept any interference received, including interference that may cause undesired operation. Changes or modifications not expressly approved by the party responsible for compliance could void the user's authority to operate the equipment.

